

# DORCHESTER OF MT. LEBANON

Dorchester of Mt. Lebanon Senior Apartments • 2903 Midland Avenue, Pittsburgh, PA 15226

Web Site: [dorchestermtleb.com](http://dorchestermtleb.com) • Information: 412-402-2479

Management Agent: Allegheny County Housing Authority



## INCOME GUIDELINES ELIGIBILITY

One Person - \$0 - 31,920

Two Persons - \$0 - 36,480

## COMMUNITY PROFILE

1 4-Story Apartment Building of 60 Apartments

52 Total One-Bedroom Apartments

(4 are Fully HC Accessible)

8 Total Two-Bedroom Apartments

(2 are Fully HC Accessible)

On-Site Property Management & Maintenance

24-Hour Emergency Maintenance Service

Electronic Access System at Building Entrances

Site-Wide Security Camera System

Community Room

Wellness Area

Decks

Reading Areas

Raised Garden Areas

Local police, fire, and emergency services

Smoke-Free Building



## DWELLING UNIT AMENITIES

Utilities included:

(gas/water/sewage/electric/trash)

Range and Refrigerator Included

Laundry Room on each floor

Tenant controlled heating & air conditioning

CATV, FIOS, & Internet available

Pullcord Alert Systems

Pets Permitted (must abide by ACHA policy)



## PROGRAMS & ACTIVITIES

Social, recreational, educational, and health wellness programs provided by American Healthcare Group, LLC

## PLACES NEARBY

Community Borders: Baldwin Township, Brookline & Dormont Borough, located within one (1) mile of Dorchester of Mt. Lebanon. 3 Banks, CVS Pharmacy, US Post Office, Aldi Grocery Store, Restaurants & Business District

TYPE B (625 SQ.FT.)  
1 BEDROOM

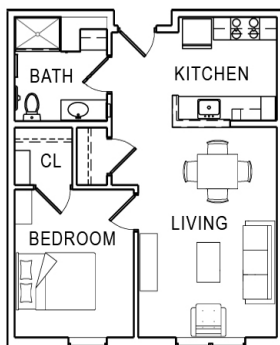

TYPE A (905 SQ.FT.)  
2 BEDROOM ACCESSIBLE

